

Airports Division

DEPARTMENT OF TRANSPORTATION
STATE OF HAWAII

PLANS FOR
KAHULUI AIRPORT
APRON LIGHTING SYSTEM EMERGENCY REPAIRS

AT

KAHULUI AIRPORT
KAHULUI, MAUI, HAWAII
PROJECT NO. CM-1424-53

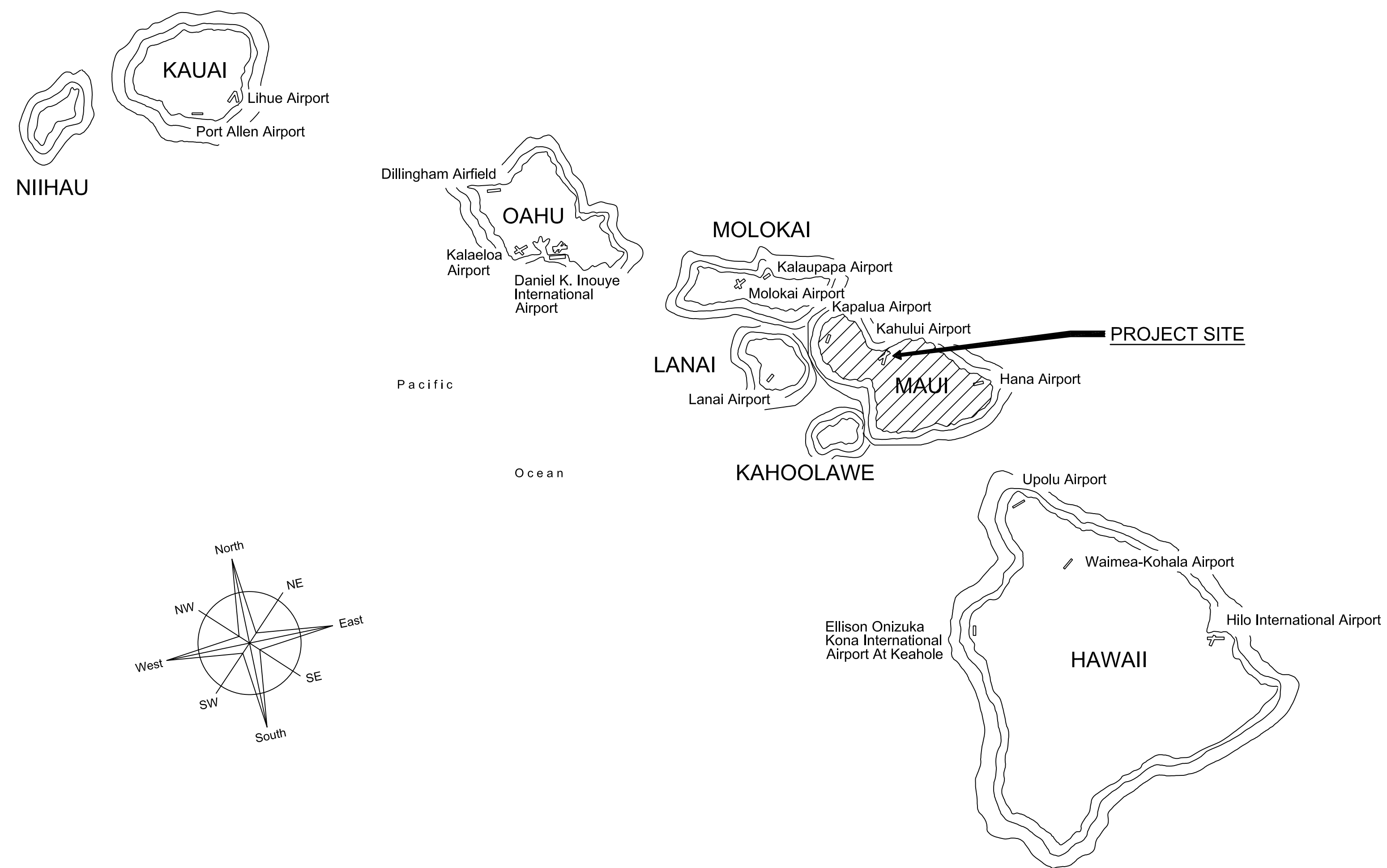

INDEX OF DRAWINGS		
DWG NO.	SHEET NO.	SHEET TITLE
1	G001	TITLE SHEET
ELECTRICAL DRAWINGS		
2	E1.00	ELECTRICAL SITE PLAN
3	E2.01	ENLARGED LIGHTING PLAN 1
4	E0.0.03	ENLARGED LIGHTING PLAN 2
5	EA.0.01	EXISTING APRON LIGHT POLE PHOTOS
6	EA.0.02	APRON LIGHT POLE DETAILS

PROJECT TEAM
PRIME / ELECTRICAL:
RONALD N. S. HO & ASSOCIATES, INC.
2153 N. KING STREET, SUITE 201
HONOLULU, HAWAII 96819
(808) 941-0577

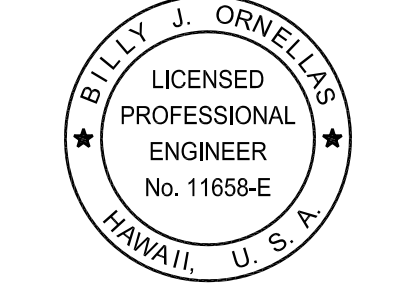

THIS WORK WAS PREPARED BY ME OR UNDER MY SUPERVISION AND CONSTRUCTION OF THIS PROJECT WILL BE UNDER MY OBSERVATION.

Willy J. Ornelas
2023.05.17
RONALD N. S. HO & ASSOCIATES, INC.
LICENSE EXPIRATION DATE: 4/30/24

DSGN.	DRWN.	CHKD.	APPD.
BO	CAD	BO	SKS

KEY PLAN / NOTES:

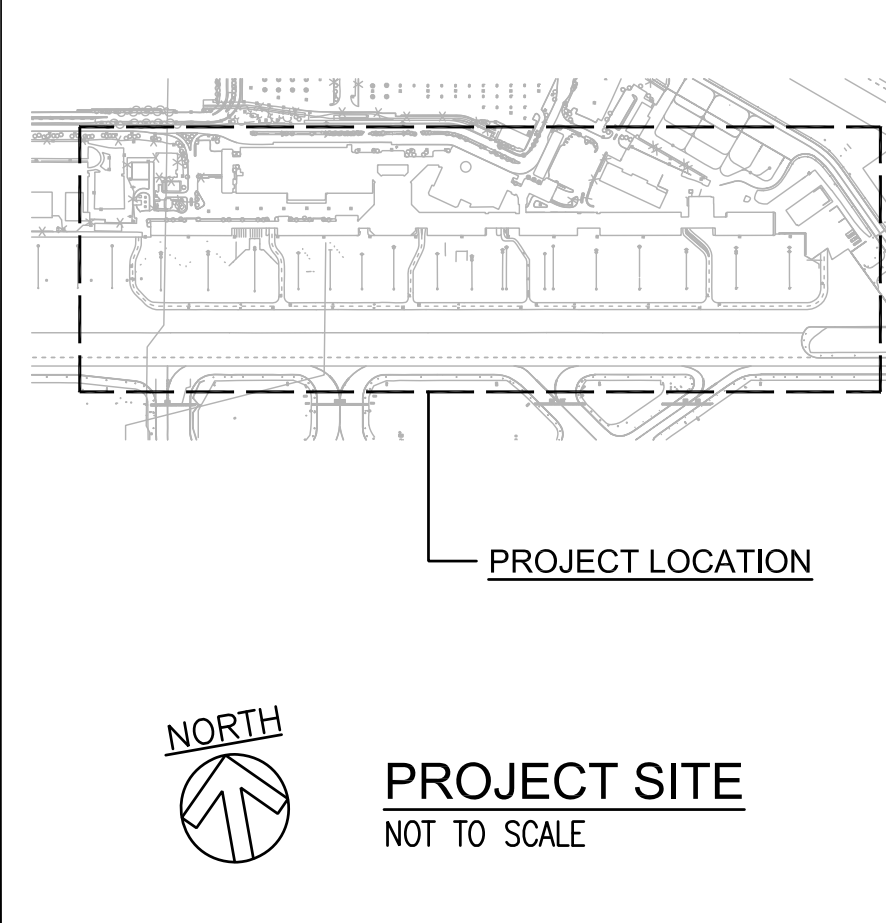
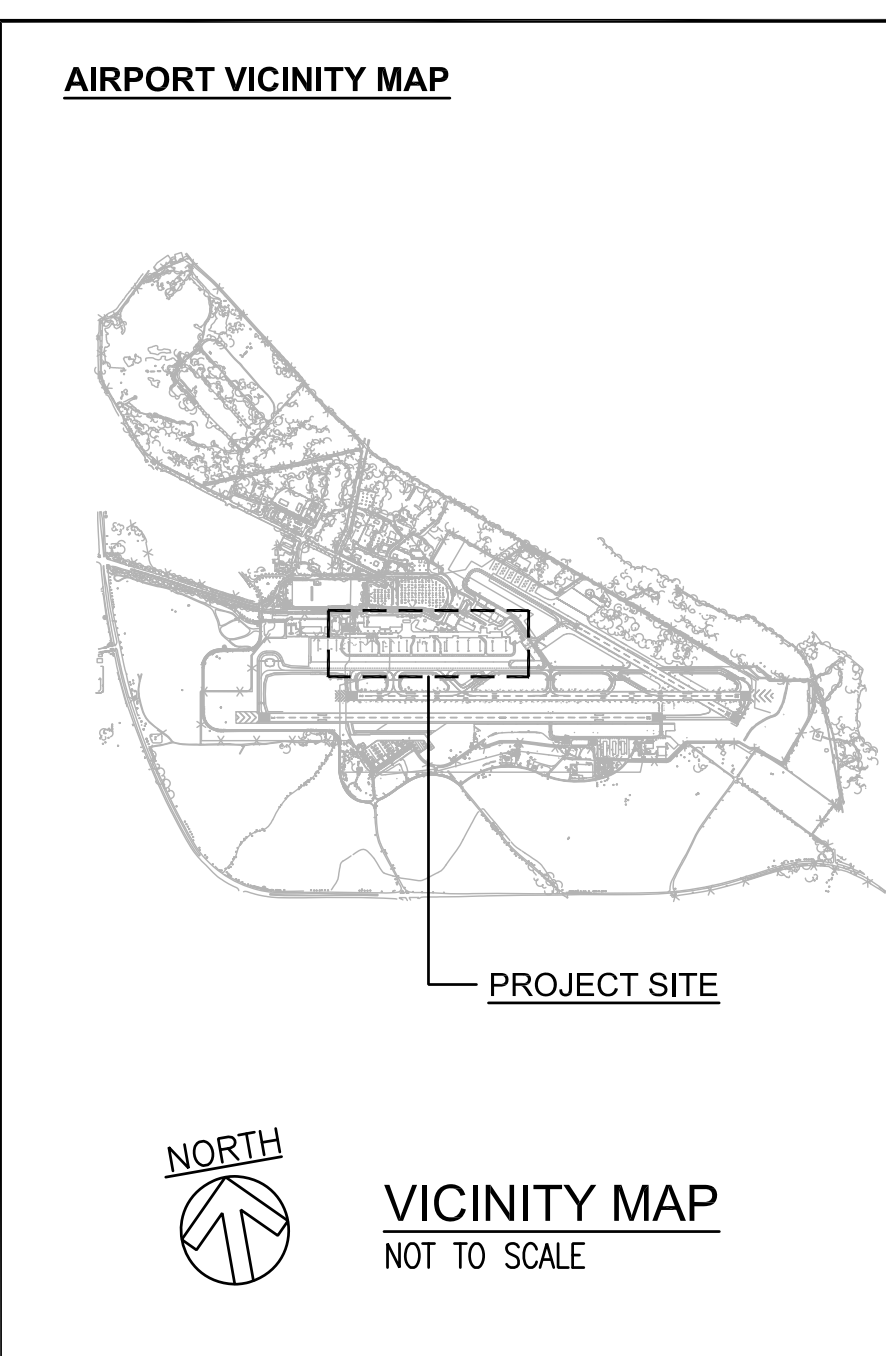

DEPARTMENT OF TRANSPORTATION
STATE OF HAWAII

APPROVED:
for *Robert H.* 9/27/23
DIRECTOR OF TRANSPORTATION DATE

NO.	DATE	REVISION

PROJECT TITLE:
KAHULUI AIRPORT APRON LIGHTING SYSTEM EMERGENCY REPAIRS
KAHULUI AIRPORT (OGG)
KAHULUI, MAUI, HAWAII

PROJECT NO.:
STATE PROJECT NO. CM1424-53

SHEET TITLE:
TITLE SHEET

DATE:	MAY 2023
DWG. NO.:	G001
1 OF 6	

2023-05-17 10:54 AM \\egp\egp\shawn\work\proj\cm1424-53\G001-211051\Title_Sheet

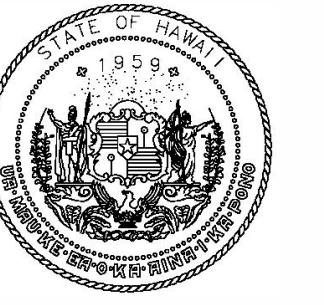

Airports Division
DEPARTMENT OF TRANSPORTATION
STATE OF HAWAII

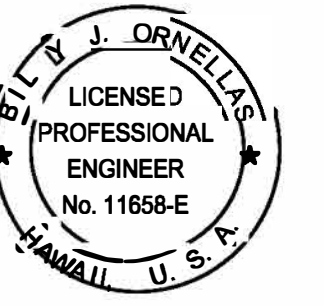

THIS WORK WAS PREPARED BY ME OR UNDER MY SUPERVISION AND CONSTRUCTION OF THIS PROJECT WILL BE UNDER MY OBSERVATION.

W. J. Drivell
2023.05.17
W. J. DRIVELL & ASSOCIATES, INC.
LICENSE EXPIRATION DATE: 4/30/24

DSGN.	DRWN.	CHKD.	APPD.
BO	CAD	BO	BO

KEY PLAN / NOTES:

NO.	DATE	REVISION

PROJECT TITLE:

KAHULUI AIRPORT APRON LIGHTING
SYSTEM EMERGENCY REPAIRS
KAHULUI AIRPORT (OGG)
KAHULUI, MAUI, HAWAII

PROJECT NO.: CM1424-53

STATE PROJECT NO. CM1424-53

SHEET TITLE:

ELECTRICAL SITE PLAN

DATE:

MAY 2023

DWG. NO.:

2 OF 6

E1.00

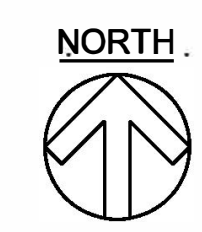
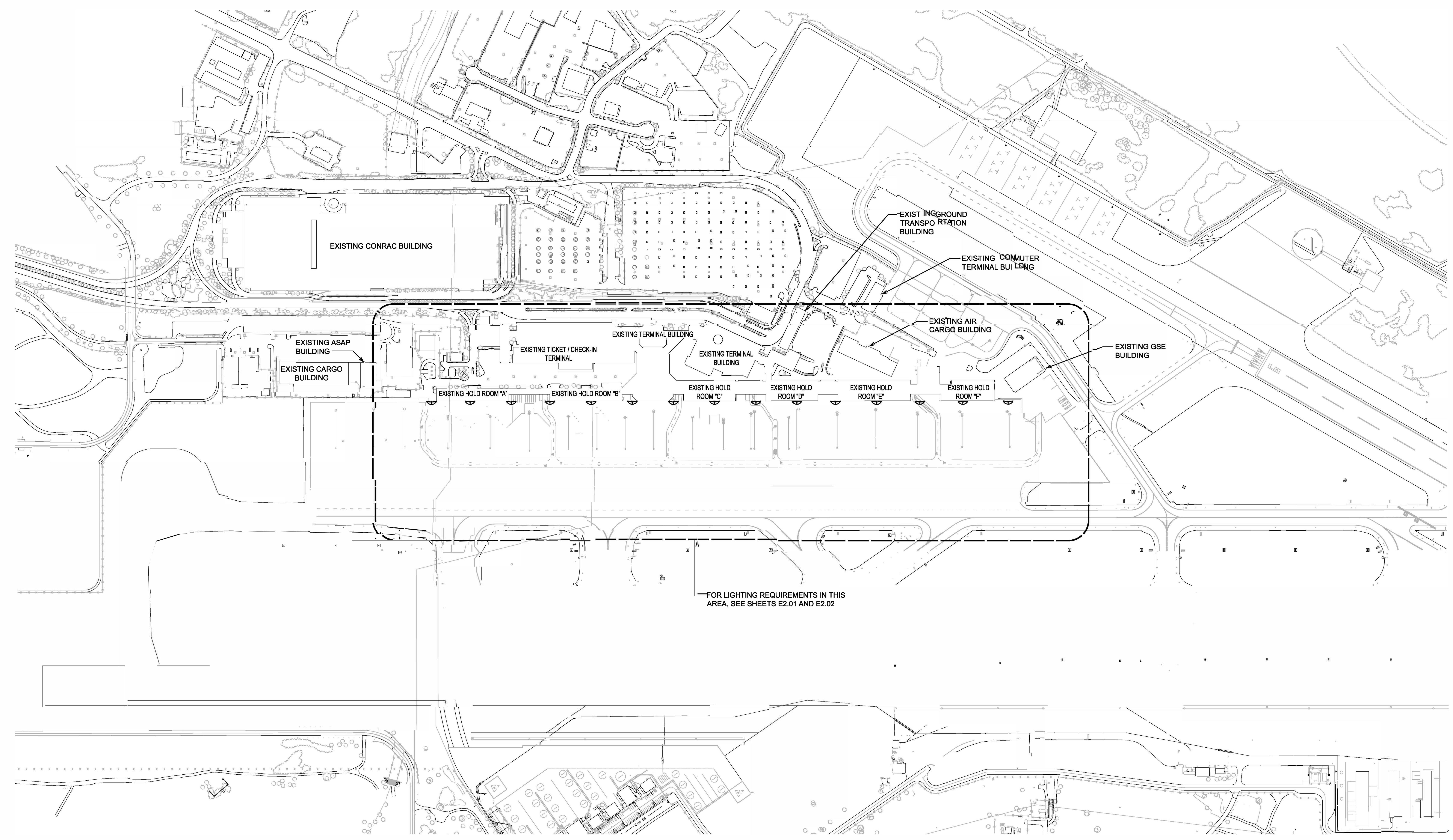

ELECTRICAL SITE PLAN
SCALE: 1"=200'

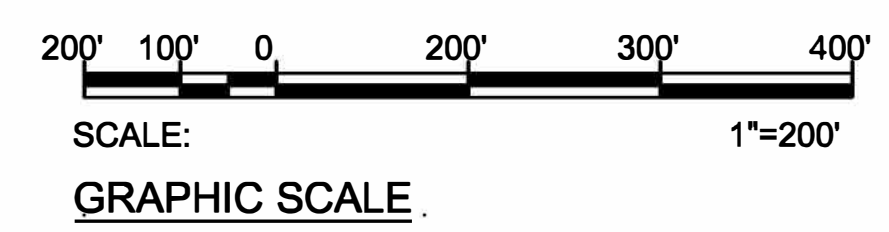

2023-05-17 10:59 AM \\gpc\work\ahorn\work\gpc\ahorn\11658-E\11658-E1.00_210517.dwg - Sheet

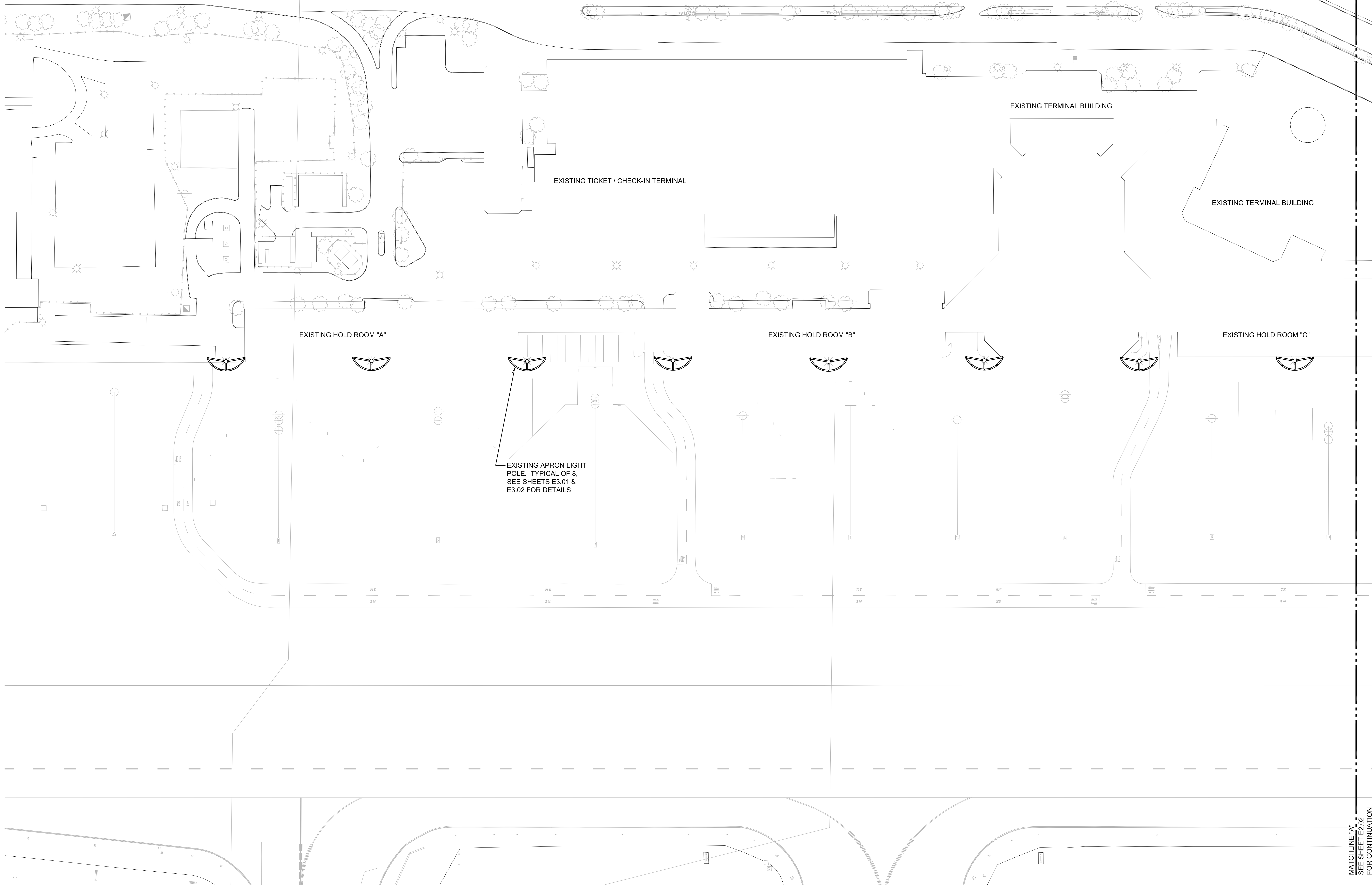

Airports Division
DEPARTMENT OF TRANSPORTATION
STATE OF HAWAII

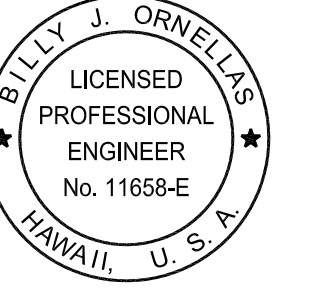

THIS WORK WAS PREPARED BY ME OR UNDER MY SUPERVISION AND CONSTRUCTION OF THIS PROJECT WILL BE UNDER MY OBSERVATION.

Willy J. Ornelas
2023.05.17
WILLY J. ORNELAS, INC.
LICENSE EXPIRATION DATE: 4/30/24

DSGN.	DRWN.	CHKD.	APPD.
BO	CAD	BO	SKS

KEY PLAN / NOTES:

NO.	DATE	REVISION

PROJECT TITLE:
KAHULUI AIRPORT APRON LIGHTING
SYSTEM EMERGENCY REPAIRS
KAHULUI AIRPORT (OGG)
KAHULUI, MAUI, HAWAII

PROJECT NO.: CM1424-53

STATE PROJECT NO. CM1424-53

SHEET TITLE:
ENLARGED LIGHTING
PLAN 1

DATE:	MAY 2023	E2.01
DWG. NO.:	3 OF 6	



ENLARGED LIGHTING PLAN 1
SCALE: 1"=50'

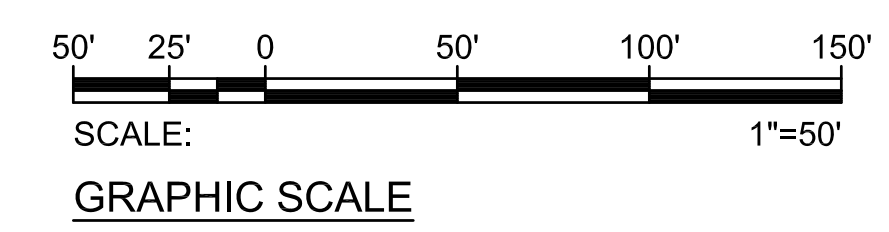

MATCHLINE "A"
SEE SHEET E2.02
FOR CONTINUATION

2023-05-17 10:58 AM \\eggsack\shared\work\projects\119501\N\ED01_219501\N_mep01

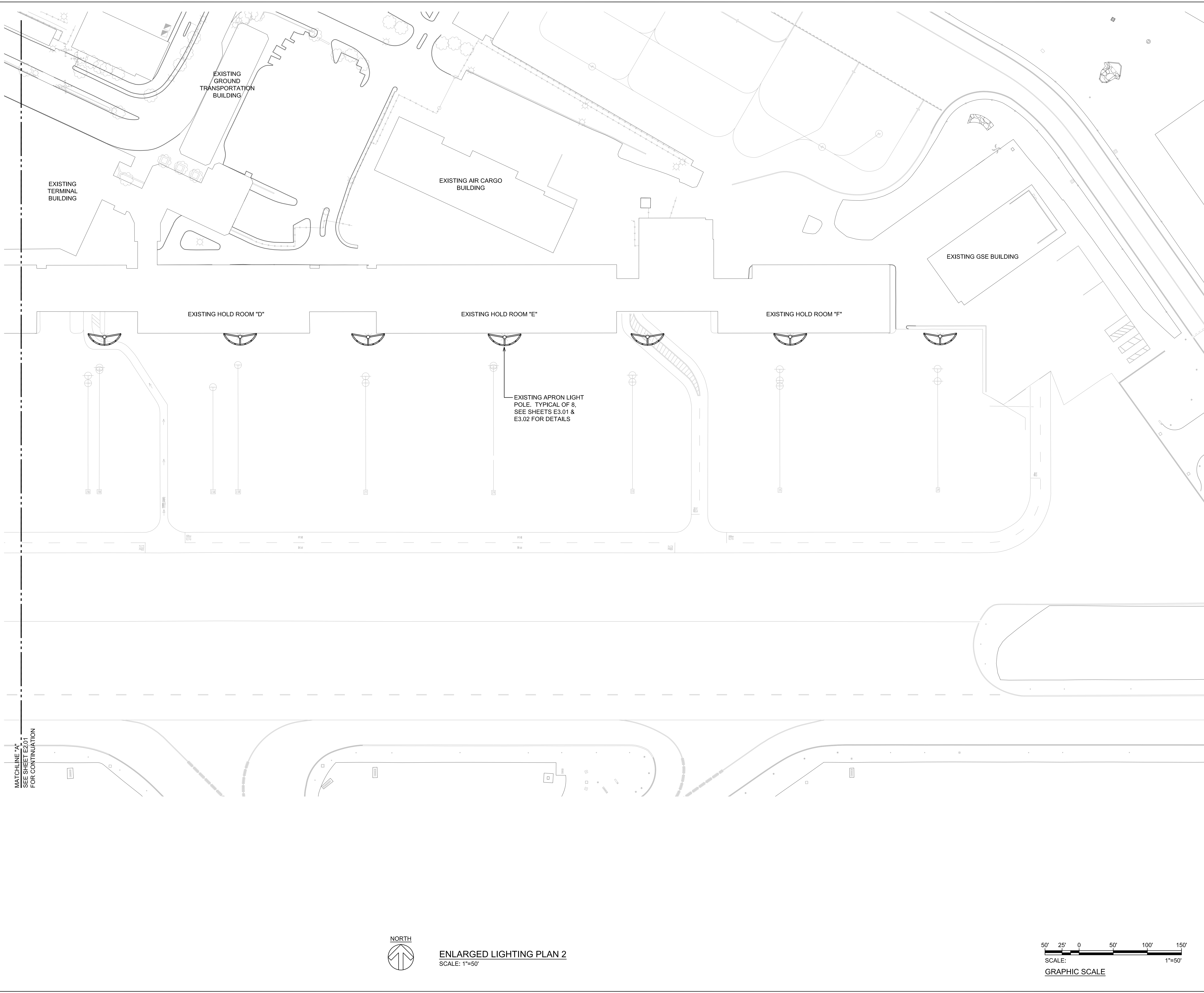

Airports Division
DEPARTMENT OF TRANSPORTATION
STATE OF HAWAII

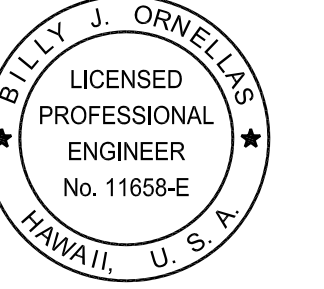

THIS WORK WAS PREPARED BY ME OR UNDER MY SUPERVISION AND CONSTRUCTION OF THIS PROJECT WILL BE UNDER MY OBSERVATION.

Willy J. Ornelas
2023.05.17
WILLY J. ORNELAS & ASSOCIATES, INC.
LICENSE EXPIRATION DATE: 4/30/24

DSGN.	DRWN.	CHKD.	APPD.
BO	CAD	BO	SKS

KEY PLAN / NOTES:

NO.	DATE	REVISION

PROJECT TITLE:
KAHULUI AIRPORT APRON LIGHTING SYSTEM EMERGENCY REPAIRS
KAHULUI AIRPORT (OGG)
KAHULUI, MAUI, HAWAII

PROJECT NO.: CM1424-53
STATE PROJECT NO. CM1424-53

SHEET TITLE:
ENLARGED LIGHTING PLAN 2

DATE:	MAY 2023	E2.02
DWG. NO.:	4 OF 6	

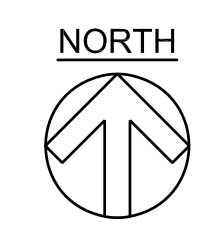

ENLARGED LIGHTING PLAN 2
SCALE: 1"=50'

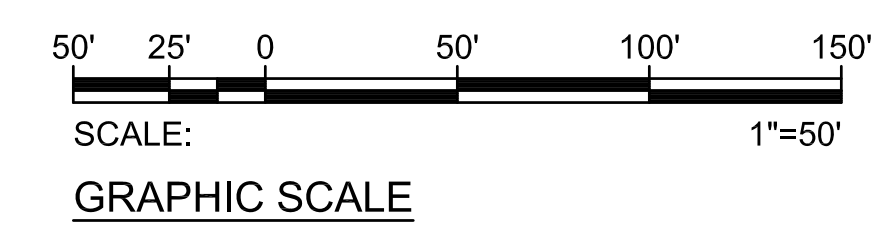

THIS WORK WAS PREPARED BY ME OR UNDER MY SUPERVISION AND CONSTRUCTION OF THIS PROJECT WILL BE UNDER MY OBSERVATION.

2023.05.17
WALD N.S. HO & ASSOCIATES, INC.
LICENSE EXPIRATION DATE: 4/30/24

DSGN.	DRWN.	CHKD.	APPD.
BO	CAD	BO	SKS

KEY PLAN / NOTES:

NO.	DATE	REVISION
-----	------	----------

PROJECT TITLE:

KAHULUI AIRPORT APRON LIGHTING SYSTEM EMERGENCY REPAIRS
KAHULUI AIRPORT (OGG)
KAHULUI, MAUI, HAWAII

PROJECT NO.: CM1424-53

STATE PROJECT NO. CM1424-53

SHEET TITLE:

APRON LIGHT POLE DETAILS

DATE:	MAY 2023
DWG. NO.:	E3.02
6 OF 6	

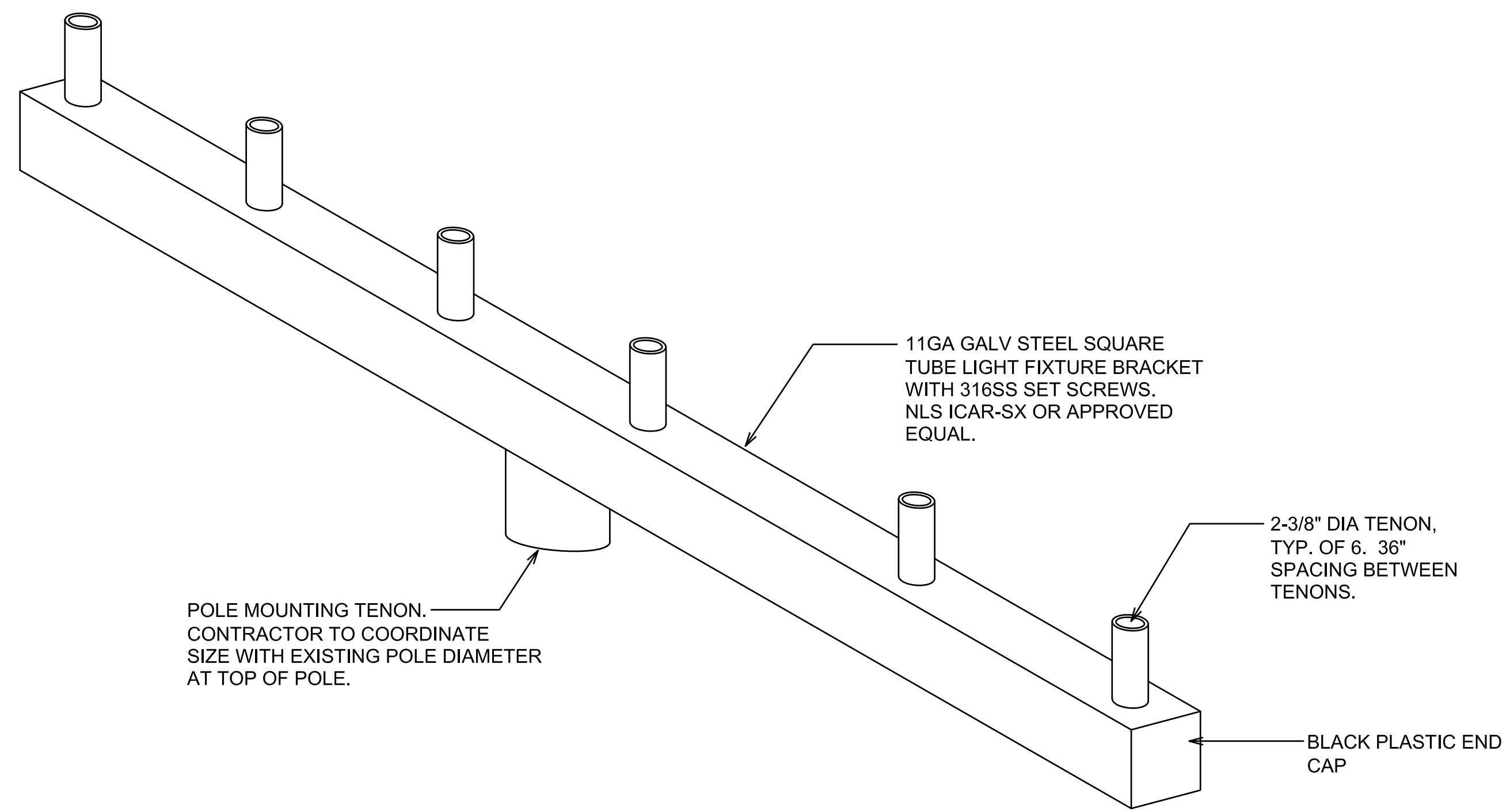

FIXTURE BRACKET DETAIL
NOT TO SCALE

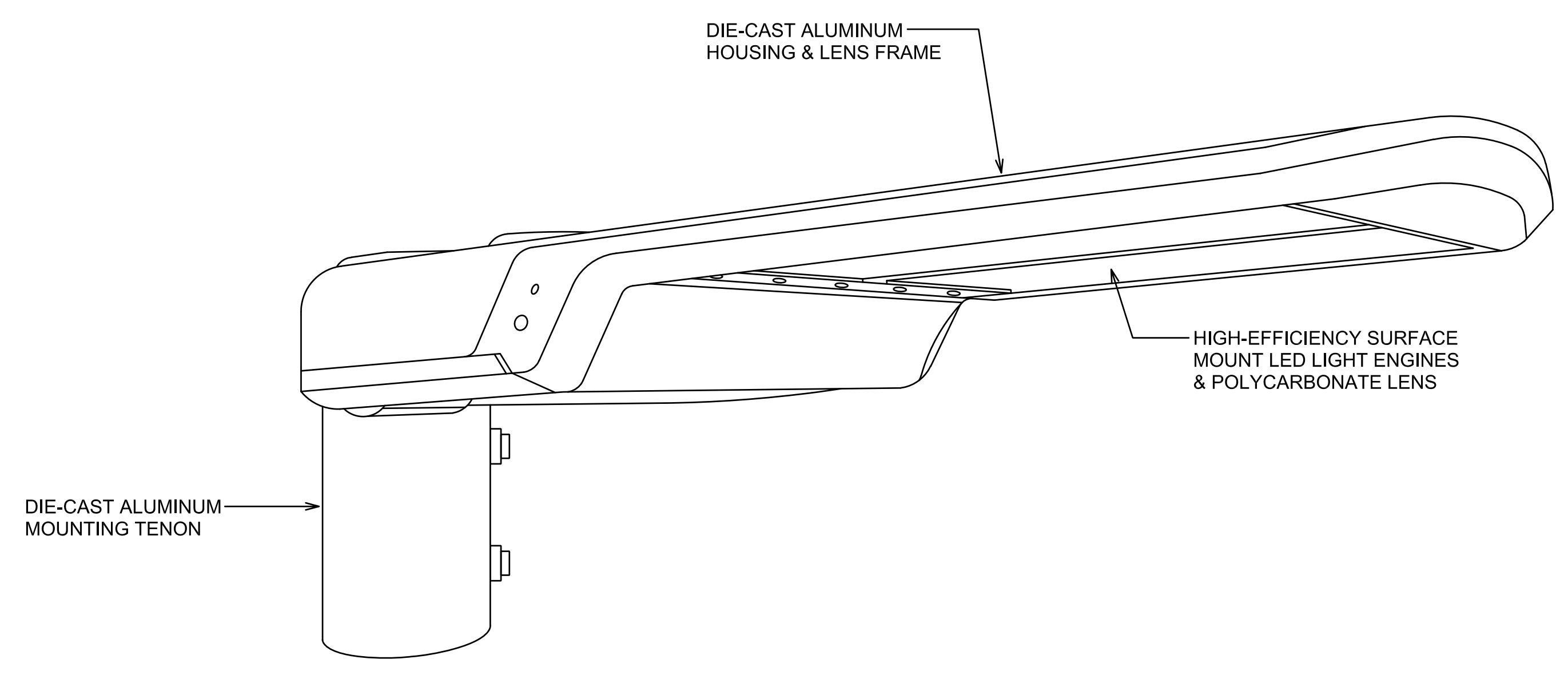

LIGHT FIXTURE: DIE-CAST ALUMINUM HOUSING, LENS FRAME AND MOUNTING TENON, HIGH-EFFICIENCY LED LIGHT ENGINE WITH POLYCARBONATE LENS, TYPE IV DISTRIBUTION, UL LISTED FOR WET LOCATIONS, IP65.
LIGHT ENGINE: 375W, 51,500 LUMENS, 4,000K, 72 CRI, 100,000 HOURS LM-80, 277V.
MANUFACTURER: RAB LIGHTING A17-4T37N / A17-SF-KIT OR APPROVED EQUAL.

LIGHT FIXTURE DETAIL
NOT TO SCALE

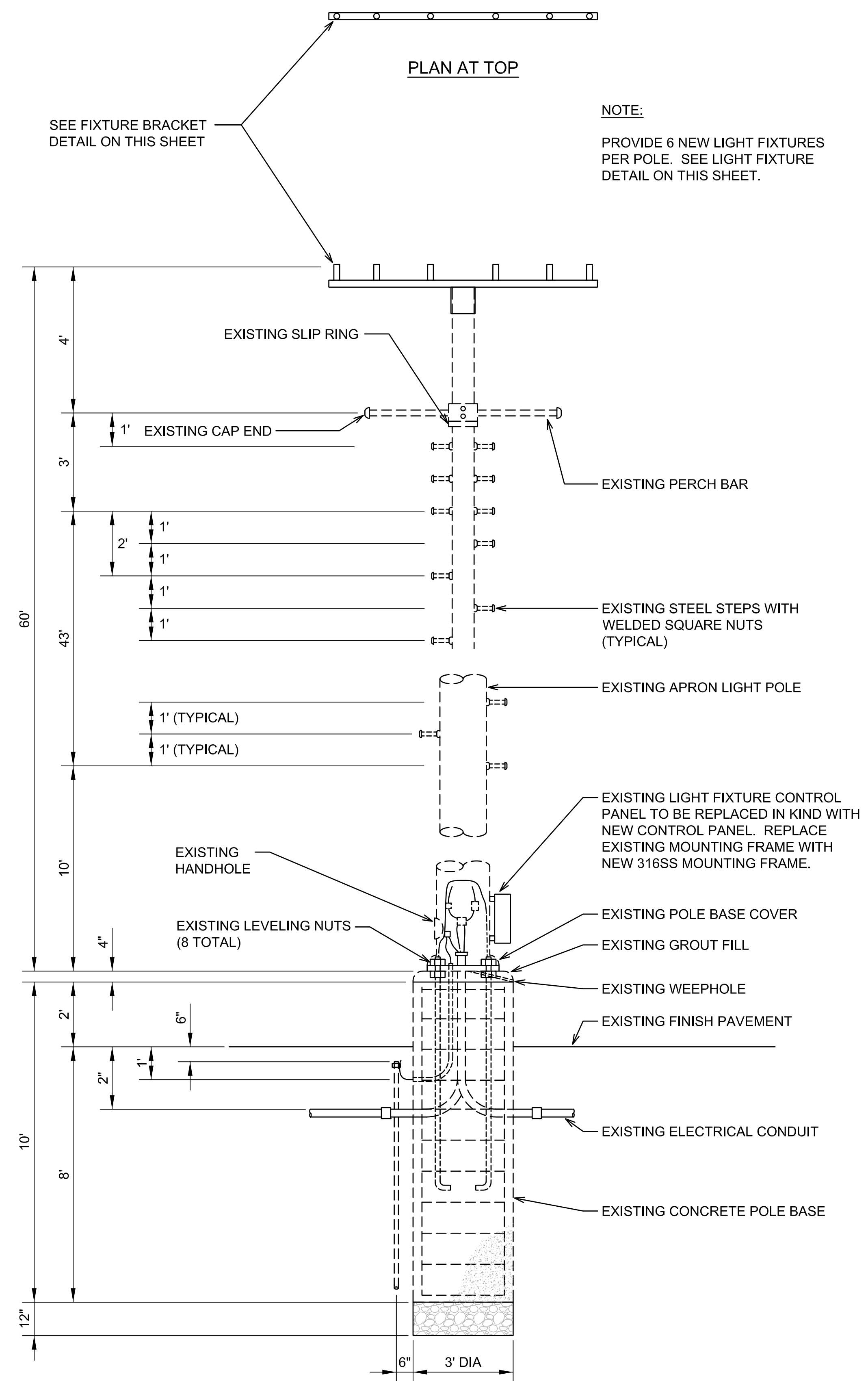

EXISTING ELEVATION

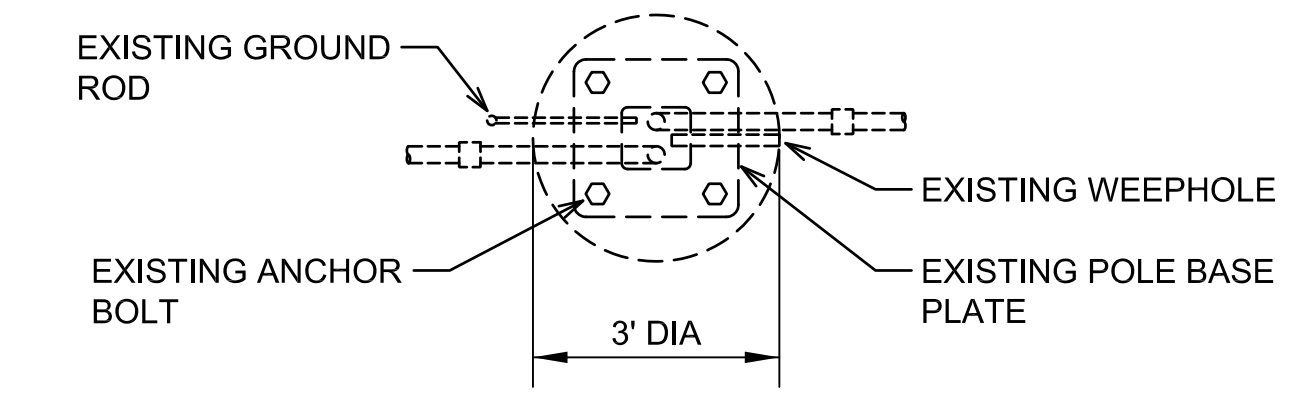

PLAN AT EXISTING POLE BASE

APRON LIGHT POLE DETAIL
NOT TO SCALE